

GENESIS 12

GET OUT ABRAHAM !

ABRAHAM BASICS

- DATES ARE NOT UNIVERSALLY AGREED UPON
- BORN ABOUT 2000 BC
- NOAH ABOUT 892, SHEM ABOUT 390
- ABOUT 58 WHEN NOAH DIES, 110 AT SHEM'S DEATH
- SOME EXTRA-BIBLICAL BOOKS (Enoch) INDICATE THAT ABE SPENT SIGNIFICANT TIME WITH SHEM

ABRAHAM BASICS

- ADAM TO ABRAM 1950 YEARS
- ADAM TO NOAH 1056 YEARS
- NOAH TO FLOOD 600 YEARS
- FLOOD TO BABEL 106 YEARS
- BABEL TO ABRAM 292 YEARS
- ABRAM TO EGYPT 290 YEARS

FAMILY LINE

- **HAM, SHEM, JAPHETH (Generally):**
 - Ham = Canaanites, Babylonians, Egyptians
 - Japheth = Mediterranean (Europe) Black Sea (Russia)
 - Shem = Did not travel as far, area “in between”
Semites
- **ABRAM WAS FROM SHEM**
- **NIMROD OUT OF HAM, PLAIN OF SHINAR, BABYLON. “TOWER” MAY HAVE BEEN A ZIGGURAT - CENTER FOR / TEMPLE FOR god WORSHIP.**

RELIGION OF THE TIME

- SUMERIA LOCATED IN SOUTHERN MESOPOTAMIA 4th MILLENUM BC. URBAN SOCIETY. WRITTEN LANGUAGE. CENTER FOR gods WORSHIP.
- ZIGGURATS THROUGH THE “FERTILE CRESCENT” AS TEMPLES. EACH CITY WORSHIPPED A god.
- THE ZIGGURAT IN BOTH SOUTHERN AND NORTHERN UR WAS TO WORSHIP NAMMU - THE MOON god.

The Fertile Crescent/Mesopotamia



ZIGGURAT OF UR

ARTISTS CONCEPTION



CIRCA 1930

US SOLDIERS AT REBUILT
ZIGGURAT



EAU "WORLD MOTHER"
CIRCA 2400



HISTORICAL / CULTURAL CONTEXT

- EGYPT HAD 12 DYNASTIES BEFORE JACOB WAS BORN. PYRAMIDS BEFORE ABRAM.
- SIGNIFICANT TRADE BETWEEN EGYPT AND BABYLON, THROUGH CANAAN WITH SIGNED TREATIES / AGREEMENTS TO PASS. TO SEA IN PHOENECIA.
- PHOENICIANS SAILED FROM ABOUT 3,000 BC. THEY TRAVELED THROUGHOUT ENGLAND, AROUND AFRICA TO RED SEA BEFORE ABRAM.

Phoenician travels



Ancient Phoenician coin



UR AT ABRAM'S TIME

- BEFORE ABRAM UR HAD SCHOOLS, COLLEGES BOOKS.
- BABYLONIAN WAS THE UNIVERSALLY EMPLOYED LANGUAGE OF TRADE / COMMERCE.
- 3rd DYNASTY OF SUMERIAN AKKADIAN RULE (WITH A BRIEF PERIOD OF SEMITIC AKKADIAN RULE).
- IRRIGATION USED. CODE OF LAWS (CODE OF NAMMU) ESTABLISHED (PRECEDED HAMMURABI BY 300 YEARS).
- TABLETS WITH SQUARE AND CUBE ROOTS. HYMNS. RECORDS OF BUILDINGS ERECTED BY KINGS

UR AT ABRAM'S TIME

- CITY STREETS
- TWO STORY HOMES WITH ENTRY ROOMS, KITCHENS, PARTIALLY COVERED COURTYARDS, BEDROOMS ON SECOND FLOOR
- BURNT BRICK EXTERIOR WALLS, BURNT BRICK FOUNDATIONS FOR INTERIOR WALLS
- COMMERCIAL BUSINESSES IN PLAZAS, ABRAM'S FATHER MADE IDOLS.
- FERTILE CRESCENT, HANGING GARDENS OF BABYLON, LANDSCAPED PLAZAS / STREETS

LIVING IN UR

RESIDENTIAL STREET



INTERIOR COURTYARD

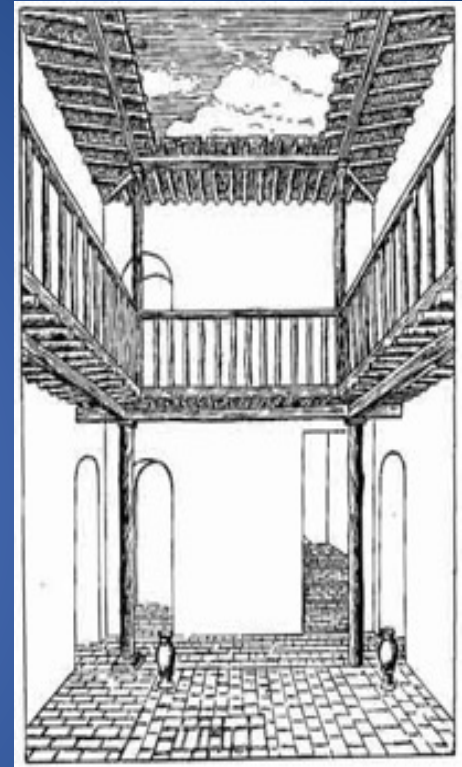

EXCAVATED KITCHEN



JOURNEYS

- UR TO HARAN 600 MILES
- HARAN TO SCHECHEM 400 MILES
- SHECHEM TO BEIT EL 20 MILES
- BETHEL TO EGYPT 225 MILES
- BETHEL TO HEBRON 35 MILES
 - BETHEL TO JERUSALEM 15 MILES
 - JERUSALEM TO HEBRON 20 MILES
- HEBRON TO HOBAB 160 MILES
(Near Damascus, Retrieving Lot)

PLACES ARE IMPORTANT

- SHECHEM: IN VALLEY AT BASE OF MT'S EBAL and GERAZIM. DINAH RAPED THERE. JOSEPH BURIED THERE. YESHUA AND WOMAN AT WELL.
- BEIT- EL: ON ROAD TO JERUSALEM, SOUTH OF SHECHEM. BUILDS ALTAR THERE. JACOB LIVES THERE AFTER RETURN. GUILD PROPHETS AT ELISHA'S TIME GOLDEN CALF PLACED THERE
- JOSHUA ASSIGNED HEBRON TO CALEB. DAVID RULED FROM THERE 7 YEARS.

makes 3 promises (nation, land, seed)
an and tells him to move to Canaan.
is an altar after God repeats promises.
thel and Ai and builds an altar.
drought and sees the Pyramids.
moves east & God repeats promises.
ks of a man named Mamre.

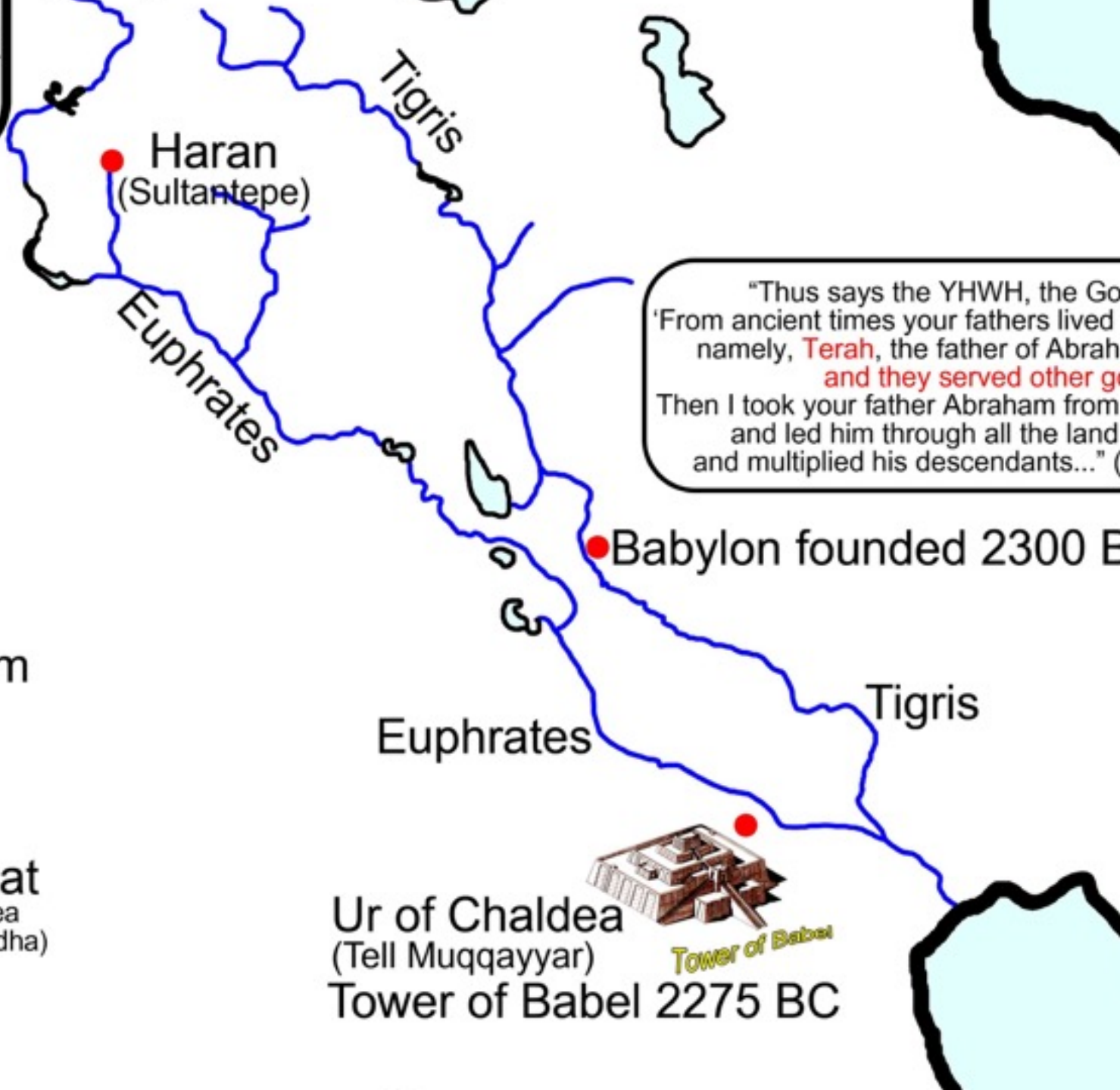

"Thus says the YHWH, the Go
'From ancient times your fathers lived
namely, **Terah**, the father of Abrah
and they served other g
Then I took your father Abraham from
and led him through all the land
and multiplied his descendants..." (

Babylon founded 2300 B

Shechem
Ai

En Mishpat
(Kadesh Barnea
Gen 14:7; El Beidha)

Ur of Chaldea
(Tell Muqqayyar)
Tower of Babel 2275 BC



THE CALL

- CALLED OUT OF A CULTURE OF gods WORSHIP
- MOVES TO PLACE THAT WORSHIPS SAME god. UR and HARAN WORSHIPPED NAMMU.
- FATHER (Terach) DIES AT 205. (Abram born when Terach is about 70.
- LEAVES HARAN AT 75 YEARS OLD WITH POSESSIONS AND PEOPLE (SOULS) AND ENTERS KENA'AN. LIVES 100 YEARS MORE.